

## TURKISH DROP SPINDLE

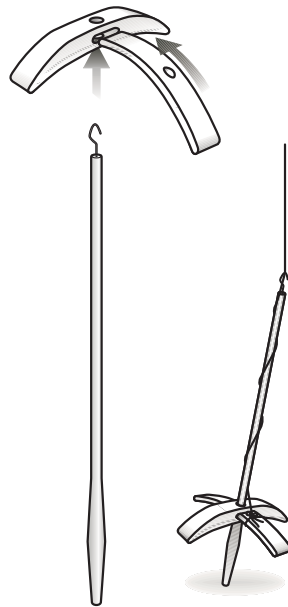

**1** Assemble the spindle. Tie a leader (a piece of yarn 1m/40") to the shaft under the whorl, wrap it around the shaft & under the hook.

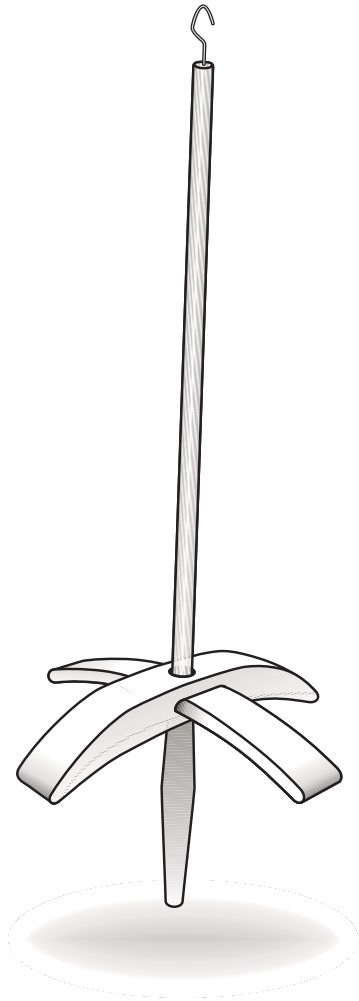
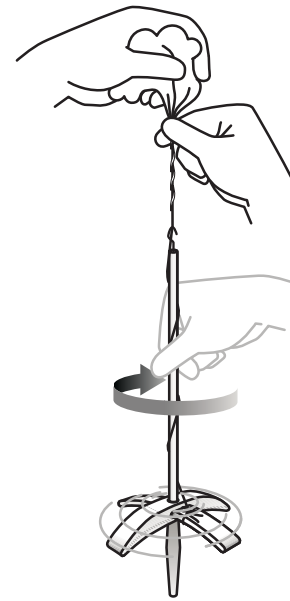

**2** Spin the spindle clockwise & allow the leader to join onto your prepared fibres.

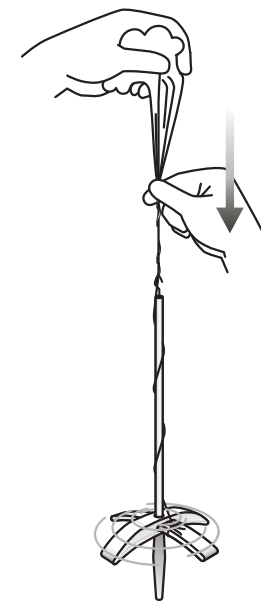

**3** While keeping the leader pinched with one hand, draft the fibres down.

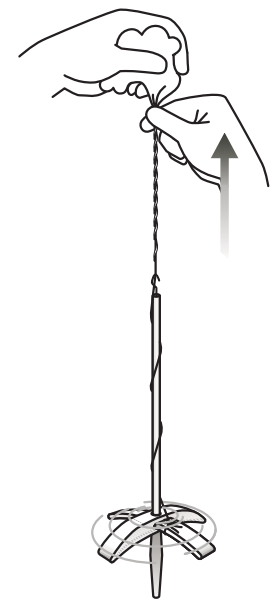

**4** Slowly slide your fingers back up the drafted fibres allowing the twist to follow. Once twisted, the yarn will support the weight of the spindle.

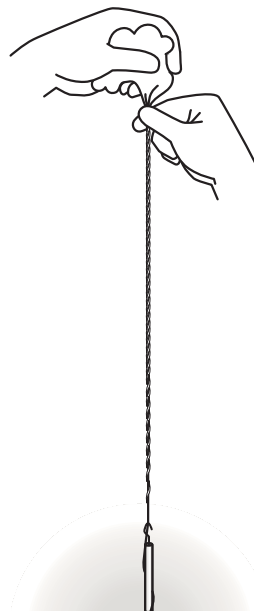

**5** Keep the spindle spinning while drafting more yarn until the spindle reaches the floor.

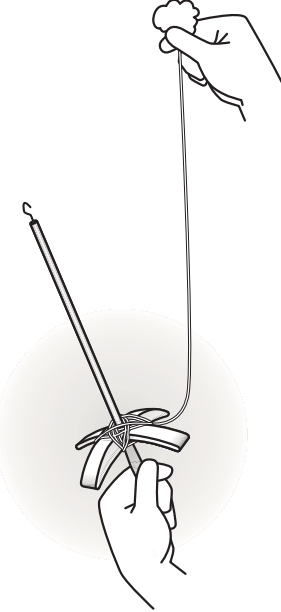

**6** Wind the yarn around the cross bars to form a ball. Then repeat the process 1 - 6 until you have a full ball.

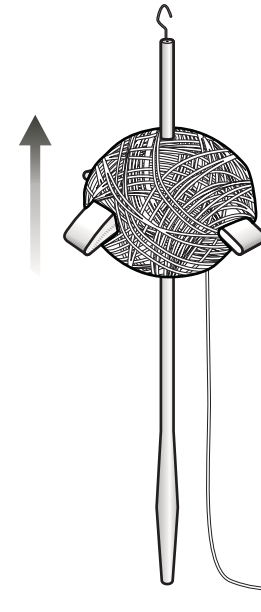

**7** Slide the ball and cross bars off the shaft, first remove the narrow cross bar, then the thicker bar. Now your ball is ready to use either as a single ply or ply 2 together with the spindle spinning anti-clockwise.

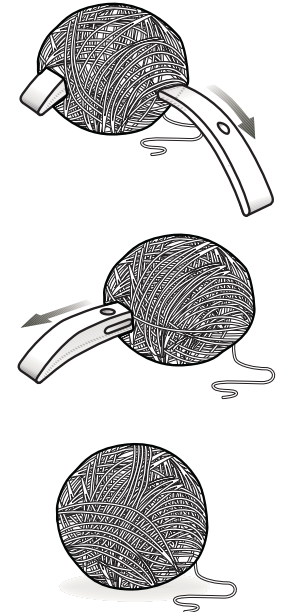

**Ashford Guarantee**

Thank you for purchasing this Ashford product. In the unlikely event there is any fault in manufacture we will replace the item. To validate our guarantee please register on our website or write to us.  
Please also join our Ashford Club for the Wheel Magazine, competitions and more at [www.ashfordclub.co.nz](http://www.ashfordclub.co.nz)